



## Vestil Manufacturing Corp.

2999 North Wayne Street, P.O. Box 507, Angola, IN 46703

Telephone: (260) 665-7586 -or- Toll Free (800) 348-0868

Fax: (260) 665-1339

Web: [www.vestilmfg.com](http://www.vestilmfg.com) e-mail: [info@vestil.com](mailto:info@vestil.com)

# CCM-Series Coil Movers Instruction Manual

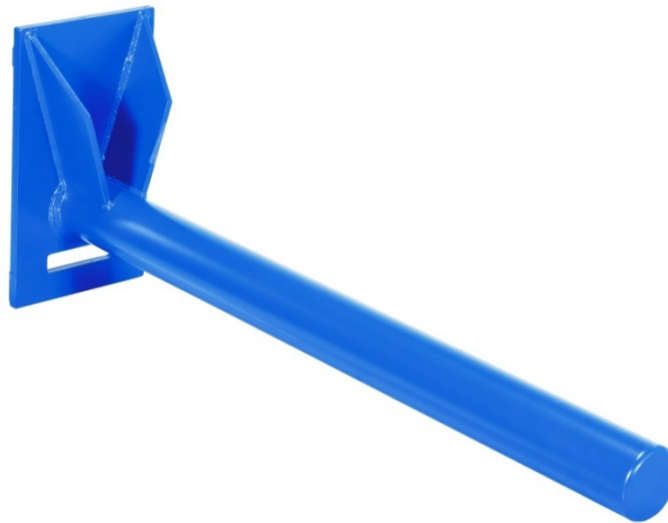

### Receiving Instructions

After delivery, remove the packaging from the product. Inspect the product closely to determine whether it sustained damage during transport. If damage is discovered, record a complete description of it on the bill of lading. If the product is undamaged, discard the packaging.

**NOTE:** The end-user is solely responsible for confirming that product design, use, and maintenance comply with laws, regulations, codes, and mandatory standards applied where the product is used.

### Technical Service & Replacement Parts

For answers to questions not addressed in these instructions and to order replacement parts, labels, and accessories, call our Technical Service and Parts Department at (260) 665-7586. The Department can also be contacted online at <https://www.vestil.com/page-parts-request.php>.

### Electronic Copies of Instruction Manuals

Additional copies of this instruction manual may be downloaded from <https://www.vestil.com/page-manuals.php>.

## TABLE OF CONTENTS

	PAGE
Signal Words.....	2
Safety Instructions.....	2
CCM (Class 2 Carriage) Exploded View, Bill of Materials, Specifications.....	3
CCM (Class 3 Carriage) Exploded View, Bill of Materials, Specifications.....	4
National Standards.....	5
Installing the Coil Mover.....	5
Using the Coil Mover.....	6
Record of Satisfactory Condition.....	6
Inspections.....	6
Maintenance.....	7
Labeling Diagram.....	7
Limited Warranty.....	8

## SIGNAL WORDS

This manual uses SIGNAL WORDS to direct the reader's attention to important safety-related messages. These messages describe actions or omissions that could result in personal injury or property damage. Each signal word corresponds to a specific hazard level.



Identifies a hazardous situation which, if not avoided, **WILL** result in DEATH or SERIOUS INJURY. Use of this signal word is limited to the most extreme situations.



Identifies a hazardous situation which, if not avoided, **COULD** result in DEATH or SERIOUS INJURY.



Indicates a hazardous situation which, if not avoided, **COULD** result in MINOR or MODERATE injury.



Identifies practices likely to result in product/property damage, such as operation that might damage the product.

## SAFETY INSTRUCTIONS

Vestil strives to identify all foreseeable hazards associated with the use of its products. However, material handling is dangerous and no manual can address every conceivable risk. Ultimately, the most effective way to prevent injury is to apply sound judgment whenever using this device.

### WARNING

Risk of death or serious personal injuries.

- This coil mover is a front end attachment for lift trucks. Contact the manufacturers of all forklifts that will use the attachment before putting the attachment into service. Lift truck manufacturers must provide: 1) written approval to use the attachment; and 2) markings for each forklift that identify the coil carrier AND give the approximate weight of the forklift and carrier at maximum elevation with a laterally-centered load. **DO NOT use the coil mover until your forklifts are marked.** If the forklift manufacturer does not respond to your request for approval or refuses to provide approval, then a qualified, registered professional engineer may provide written approval.
- DO NOT exceed the capacity. See Label 1153 on product; also shown in [LABELING DIAGRAM](#) on p. 7. THE CAPACITY OF THE TRUCK AND COIL MOVER COMBINATION MIGHT BE LESS THAN THE CAPACITY SHOWN ON THE COIL MOVER. CONSULT THE LIFT TRUCK NAMEPLATE AND UPDATED CAPACITY MARKINGS.
- Lift trucks equipped with front end attachments, like this coil mover, behave as partially loaded trucks even when operated without a load on the attachment.
- Read and understand the entire manual before installing, using, or servicing the product. A copy of this manual must be available at all times to everyone who uses or maintains the unit. Read the manual to refresh your understanding of use, inspection, and maintenance procedures whenever necessary.
- Before attaching the coil mover to the carriage of your fork lift, qualified inspection personnel should inspect the carriage and confirm nominal condition.
- Make sure that the coil (load) is stable on the mover by lifting the coil just a few inches above the ground. Load swing should be minimal. If the load is unstable, return it to the ground and use another piece of equipment to transport it.
- Inspect the coil mover as described in [INSPECTIONS](#) on p. 6.
- ALWAYS follow applicable operating safety rules and practices described in the current revision of [ANSI/ITSDF B56.1, "Safety Standard for High Lift and Low Lift Trucks"](#) (the "Standard") as well as all Occupational Safety and Health regulations that govern use of front end attachments in the jurisdiction(s) where the coil mover is used. The Standard is downloadable for free from the ITSDF website ([www.ITSDF.org](http://www.ITSDF.org)).
- DO NOT deface, obscure, or remove any label. Verify the location and legibility of all labels shown in the [LABELING DIAGRAM](#) on p. 7. DO NOT use this device UNLESS all product labels are easily readable and undamaged.
- DO NOT ride or sit on the coil mover or the load.
- DO NOT use the coil mover to push objects.
- Only use the product to transport a single coil of material at a time. Coils must not hang over the end of the pole. See [USING THE COIL MOVER](#) on p. 5 for loading instructions.
- ONLY use this product when traveling on improved, level, even surfaces.
- DO NOT leave the lift truck unattended. Always lower the load to the ground before leaving the forklift.
- DO NOT modify the product in any way UNLESS you first obtain written approval from Vestil. Unapproved modifications automatically void the LIMITED WARRANTY (see p. 8) and might make the product unsafe to use.

## EXPLODED VIEW: CCM-SERIES COIL MOVERS, CLASS 2 CARRIAGE

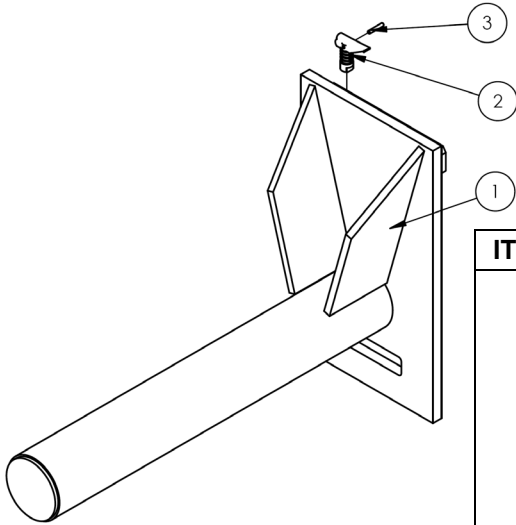

ITEM	PART NO.	DESCRIPTION	QTY
1	08-514-242	WELDMNT, FRAME, COIL MOVER CCM-24-4	1
	08-514-246	CCM-24-5	1
	08-514-243	CCM-36-4	1
	08-514-247	CCM-36-5	1
	08-514-244	CCM-48-4	1
	08-514-246	CCM-48-5	1
	08-514-245	CCM-60-4	1
	08-514-249	CCM-60-5	1
	2	08-154-004	KIT, CARRIAGE LOCK MECHANISM
3	40580	SPRING PIN, HEAVY DUTY, PLAIN FINISH, M5 x 32mm	1

## SPECIFICATIONS

Documents that provide specifications for CCM-series coil movers are available online to anyone who visits Vestil's website. Specifications include dimensions, net weight, and capacity information. To access the appropriate specifications document, navigate to this webpage: <https://www.vestil.com/product.php?FID=497>. Click the "Specifications" tab. Scroll the page to the entry for the model ladder you purchased, and click the button in the "PDF" column that looks like a pencil inside a blue-bordered box. A PDF file will open. This file is the specifications document. Print a copy of the document and keep it with your copy of this manual. The following is an example specifications document for, in this case, model CCM-24-4.

**SPECIAL CARRIAGE MOUNTED COIL RAM - CCM-24-4** APPROX WEIGHT: 104.01 lbs.  
DOES NOT INCLUDE WEIGHT OF POWER OR PACKAGING!!!

\*\*\* ANY ADDITIONS, DELETIONS, OR OMISSIONS MUST BE CORRECTED ON THIS DRAWING AS THIS DRAWING WILL BE CONSIDERED ALL INCLUSIVE \*\*\*  
ALL GRAPHICS PROVIDED ARE FOR REFERENCE ONLY. IF CERTAIN DIMENSIONS ARE CRITICAL PLEASE VERIFY THOSE DIMENSIONS WITH YOUR SALESPERSON

**STANDARD FEATURES**

MODEL NUMBER IS CCM-24-4  
OVERALL WIDTH IS 11 1/2"  
OVERALL LENGTH IS 31"  
USABLE RAM LENGTH IS 24"  
OVERALL HEIGHT IS 20 1/2"  
UNIFORM CAPACITY IS 3,000 LBS.  
RAM O.D. IS 4 1/2"  
FITS STANDARD CLASS II CARRIAGE

**SPECIAL FEATURES**  
NONE

HORIZONTAL CENTER OF GRAVITY: 9.79"  
VERTICAL CENTER OF GRAVITY: 6.16"  
EFFECTIVE THICKNESS: LESS THAN 1"  
LOST LOAD: 104.01 lbs.

**DETAIL A SCALE 1:10**

**\*\*NOTE\*\***  
DUE TO VARIATIONS IN FORK TRUCK CARRIAGES, PLEASE HAVE THE CUSTOMER VERIFY THAT THEIR CARRIAGE WILL CONFORM TO THE DIMENSIONS SHOWN TO THE RIGHT. IF NOT, PLEASE HAVE THE CUSTOMER VERIFY DIMENSIONS B, T2, T3, & H4 TO BE ABLE TO QUOTE A SPECIAL BACKPLATE TO FIT.

DIMENSION TOLERANCE ± 1/4"

I, THE UNDERSIGNED, AGREE THAT THE PRODUCT AS REPRESENTED SATISFIES DESIGN AND DIMENSION REQUIREMENTS. I ALSO ACKNOWLEDGE MY DUTY TO CONFIRM PRODUCT AND INSTALLATION COMPLIANCE WITH ALL APPLICABLE FEDERAL, STATE AND LOCAL REGULATIONS AND STANDARDS.  
**ANY MODIFIED UNITS ARE NON-RETURNABLE**  
[ ] As drawn [ ] As marked

Signed: \_\_\_\_\_ Date: \_\_\_\_\_  
Printed Name: \_\_\_\_\_  
LEAD TIME WILL START UPON RECEIPT OF SIGNED APPROVAL DRAWING

FOR INTERNAL USE ONLY PROJECT SIGN OFF		DISTRIBUTOR'S NAME: <b>VESTIL MANUFACTURING</b>	P.O.# X
SALES		DRAWN BY:	W.O.# X
ENG.		DATE: 5/18/2016	SALES: X
FAB.		REFERENCE: X	SCALE: 1:16
POWER		QUOTED LEAD TIME: X	FILE NAME: 08-007-270
		QUOTE # X	

## EXPLODED VIEW: CCM-SERIES COIL MOVERS, CLASS 3 CARRIAGE

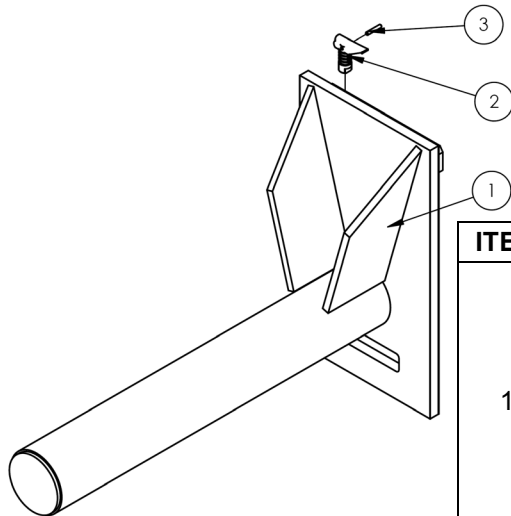

ITEM	PART NO.	DESCRIPTION	QTY
1		<u>WELDMENT, FRAME, COIL MOVER</u>	
	08-514-250	CCM-24-4-CL3	1
	08-514-254	CCM-24-5-CL3	1
	08-514-251	CCM-36-4-CL3	1
	08-514-255	CCM-36-5-CL3	1
	08-514-252	CCM-48-4-CL3	1
	08-514-256	CCM-48-5-CL3	1
	08-514-253	CCM-60-4-CL3	1
08-514-257	CCM-60-5-CL3	1	
2	08-154-004	KIT, CARRIAGE LOCK MECHANISM	1
3	40580	SPRING PIN, HEAVY DUTY, PLAIN FINISH, M5 x 32mm	1

## SPECIFICATIONS

Documents that provide specifications for Class 3 CCM-series coil movers are available online to anyone who visits Vestil's website. Specifications include dimensions, net weight, and capacity information. To access the appropriate specifications document, navigate to this webpage: <https://www.vestil.com/product.php?FID=497>. Click the "Specifications" tab. Scroll the page to the entry for the model ladder you purchased, and click the button in the "PDF" column that looks like a pencil inside a blue-bordered box. A PDF file will open. This file is the specifications document. Print a copy of the document and keep it with your copy of this manual. The following is an example specifications document for, in this case, model CCM-24-4-CL3.

**SPECIAL CARRIAGE MOUNTED COIL RAM - CCM-24-4-CL3** APPROX WEIGHT: 119.56 lbs. DOES NOT INCLUDE WEIGHT OF POWER OR PACKAGING!!!

\*\*\* ANY ADDITIONS, DELETIONS, OR OMISSIONS MUST BE CORRECTED ON THIS DRAWING AS THIS DRAWING WILL BE CONSIDERED ALL INCLUSIVE \*\*\* ALL GRAPHICS PROVIDED ARE FOR REFERENCE ONLY. IF CERTAIN DIMENSIONS ARE CRITICAL PLEASE VERIFY THOSE DIMENSIONS WITH YOUR SALESPERSON

**STANDARD FEATURES**  
 MODEL NUMBER IS CCM-24-4-CL3  
 OVERALL WIDTH IS 12"  
 OVERALL LENGTH IS 31 1/2"  
 USABLE RAM LENGTH IS 24"  
 OVERALL HEIGHT IS 24 1/2"  
 UNIFORM CAPACITY IS 3,000 LBS.  
 RAM O.D. IS 4 1/2"  
 FITS STANDARD CLASS III CARRIAGE

**SPECIAL FEATURES**  
 NONE

HORIZONTAL CENTER OF GRAVITY: 12.99"  
 VERTICAL CENTER OF GRAVITY: 5.32"  
 EFFECTIVE THICKNESS: LESS THAN 1"  
 LOST LOAD: 119.56 lbs.

**DIMENSION TOLERANCE ± 1/4"**

I, THE UNDERSIGNED, AGREE THAT THE PRODUCT AS REPRESENTED SATISFIES DESIGN AND DIMENSION REQUIREMENTS. I ALSO ACKNOWLEDGE MY DUTY TO CONFIRM PRODUCT AND INSTALLATION COMPLIANCE WITH ALL APPLICABLE FEDERAL, STATE AND LOCAL REGULATIONS AND STANDARDS. **ALL SPECIAL UNITS ARE NON-RETURNABLE** [ ] As drawn [ ] As marked

Signed: \_\_\_\_\_ Date: \_\_\_\_\_  
 LEAD TIME WILL START UPON RECEIPT OF SIGNED APPROVAL DRAWING

**APPROVAL**

FOR INTERNAL USE ONLY PROJECT SIGN OFF	DISTRIBUTOR'S NAME: VESTIL MANUFACTURING	F.O.# X
SALES	DRAWN BY:	W.O.# X
ENG.	DATE: 02/04/2015	SALES: X
FAB.	REFERENCE: X	FILE NAME:
POWER	QUOTED LEAD TIME: X	SCALE: 1:16
	QUOTE # X	08-007-278

NOTE: DUE TO VARIATIONS IN FORK TRUCK CARRIAGES, PLEASE HAVE THE CUSTOMER VERIFY THAT THEIR CARRIAGE WILL CONFORM TO THE DIMENSIONS SHOWN TO THE RIGHT. IF NOT, PLEASE HAVE THE CUSTOMER VERIFY DIMENSIONS B, T2, T3, & H4 TO BE ABLE TO QUOTE A SPECIAL BACKPLATE TO FIT.

## NATIONAL STANDARDS

According to US Federal Occupational Safety and Health Administration (OSHA) Rule 1910.178 (29 CFR 1910.178; the “Rule”), this device is a *front end attachment* for a lift truck whenever it is mounted on the forks of a lift truck. The Rule incorporates American National Standard ANSI/ITSDF B56.1 (the “Standard”) published by the Industrial Truck Standards Development Foundation (ITSDF) on its website ([www.itsdf.org](http://www.itsdf.org)). The standard is freely downloadable at <http://www.itsdf.org/cue/b56-standards.html>. Before putting this product into service, you must acquire a copy of the Standard. Apply all relevant parts of Part II: For the User. If instructions provided in this manual conflict with the Standard, then you should apply the instructions in the Standard. If you find any conflict, Vestil requests that you immediately share them with its **TECHNICAL SERVICE** personnel. Contact information for **TECHNICAL SERVICE** appears on the cover page of this manual.

## INSTALLING THE COIL MOVER

**Step 1:** Take the tines off of the carriage of your fork truck.

**Step 2:** Rotate the latch lever to the open position. Set the left side of the upper carriage bracket on the upper carriage crossbar of your lift truck.

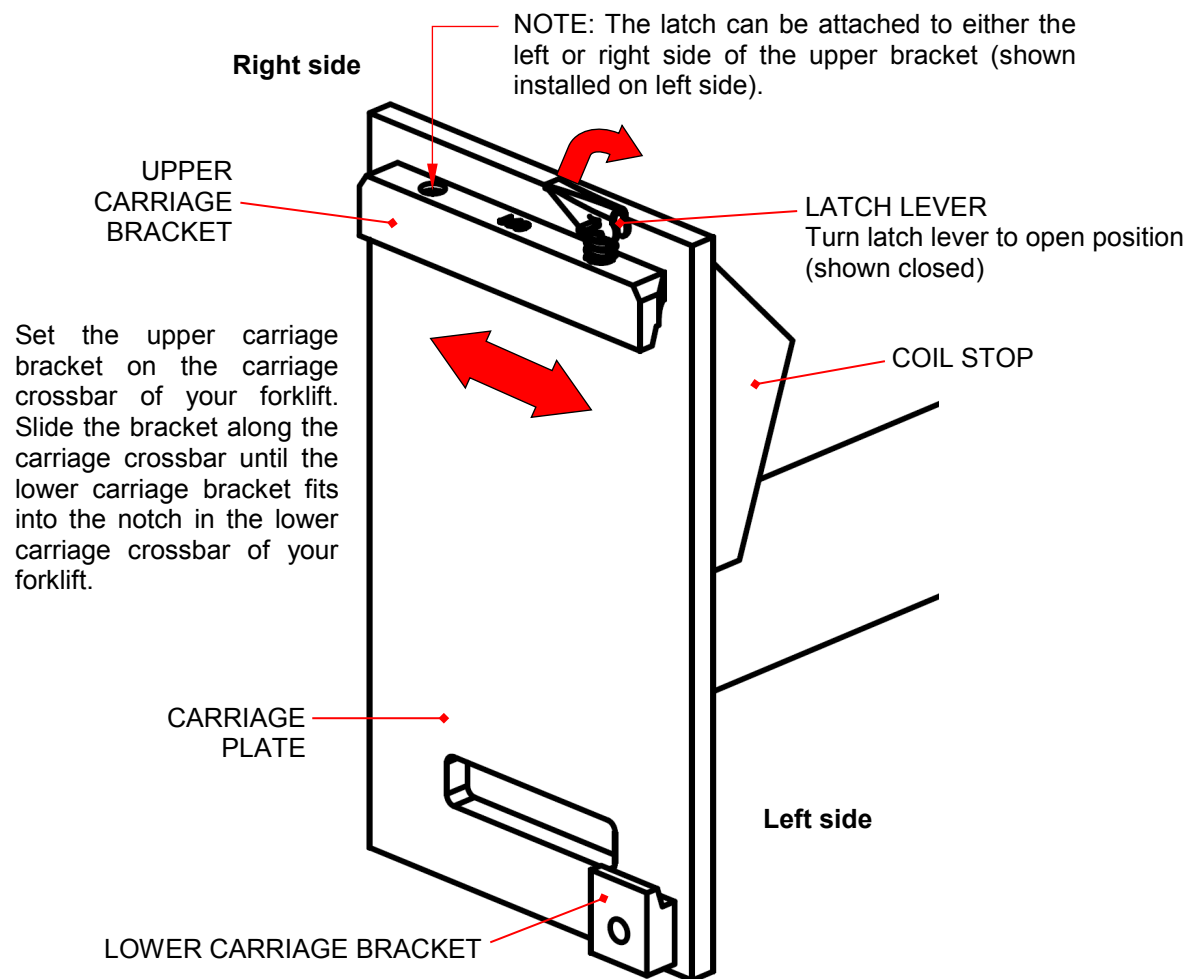

**Step 3:** Slide the upper carriage bracket along the carriage crossbar. Adjust position to allow the lower carriage bracket to fit into the notch in the lower carriage crossbar (of the forklift). The notch is probably located at the center of the crossbar. Next, slide the back plate to the left or right as necessary to center the coil mover on the carriage.

**Step 4:** Latch the coil mover to the carriage by moving the latch lever back to the closed position.

[NOTE: The latch lever will only rotate back to the closed position if the latch aligns with a notch in the upper crossbar. If necessary, adjust the position of the carriage plate until the latch aligns with a notch.]

## USING THE COIL MOVER

Engage a coil of material by driving the lift truck forward and inserting the pole through the center of the coil. Drive forward until the coil contacts the coil stop (see diagram in [INSTALLING THE COIL MOVER](#) on p. 5). You should see at least the end of the pole. The coil must not be longer than the pole. If the coil is too large, use another device to transport it. Only raise the forks as high as necessary to lift the coil off of the ground. Always watch the mover and coil during use. DO NOT leave a raised coil unattended. Always lower the carriage and unload the coil mover before leaving the forklift unattended.

## RECORD OF SATISFACTORY CONDITION

Record the condition of the device before putting it into service. Measure the gap between the upper carriage bracket and the carriage plate as well as the gap between the lower carriage bracket and the carriage plate (highlighted in the sample *SPECIFICATIONS* documents on [page 3](#) and [page 4](#); 1/2" for CCM-24-4; 5/8" for CCM-24-4-CL3). Record your measurements. Open and close the latch. Describe the amount of force necessary to operate the latch. Thoroughly photograph the unit from multiple angles. Include close range photos of all labeling, the latch mechanism in both the opened and closed positions, both the upper and lower carriage brackets, and welds, particularly the welds between the pole and the carriage plate and between the upper carriage bracket and carriage plate. Collate all photographs and writings into a single file. Mark the file appropriately to identify it. The file provides a record of the device in satisfactory condition. Compare the results of all [INSPECTIONS](#) to this *RECORD* to determine whether the unit is in satisfactory condition. If it is not in satisfactory condition, complete all necessary repair it before returning it to service. Purely cosmetic changes, like damaged paint/powdercoat, do not constitute changes from satisfactory condition. However, touchup paint should be applied to all affected areas as soon as cosmetic damage occurs to prevent rusting and corrosion. If left unaddressed, rusting/corrosion will alter the coil mover from satisfactory condition and could ultimately make it unsafe to use.

## INSPECTIONS

Inspection procedures are included in the current revision of ANSI B56.1 (the "Standard"). As stated in the [NATIONAL STANDARDS](#) section on p. 5, you must acquire a copy of the most recent revision of the Standard. Apply all use and maintenance/care instructions in the Standard. Vestil also recommends that you contact your local occupational safety and health authority to determine if any laws, regulations, codes, ordinances, etc. apply inspection requirements to products like this drum mover.

Inspections and repairs should only be performed by qualified persons. Compare the results of each inspection to the [RECORD OF SATISFACTORY CONDITION](#) (the "RECORD"). Do not use the lifter unless all parts are in satisfactory condition. Replace parts that are not in satisfactory condition before using the lifter again. **DON'T GUESS! If you have any questions about the condition of your lifter, contact the [TECHNICAL SERVICE](#) department.** The phone number is provided on the cover page of this manual. Never make temporary repairs of damaged or missing parts. Only use manufacturer-approved replacement parts. Deformities, cracks, and severe wear of the lifting arm or main body requires immediate replacement of the entire unit.

Inspect the following before each use:

1. Surfaces – Make sure that all surface of the coil pole is free of oil, grease, and other substances that could contaminate the coil material and/or affect the stability of the coil while mounted on the pole.
2. Carriage brackets – Confirm that the brackets securely engage the carriage.
3. Latch – Ensure that the coil mover is securely latched to the forklift carriage. The mover should not be able to slide (side-to-side) on the carriage.

Monthly Inspections – Perform the following inspections at least once per month

1. Hardware/fasteners – Closely examine all bolts, nuts, pins, and the latch mechanism for damage, warps, breaks, etc. Confirm that the latch operates normally.
2. Pole and carriage plate – Examine the pole and carriage plate weldment. Closely inspect the welds that fuse the pole to the carriage plate. Look for excessive wear, corrosion/rusting, damage, and metal fatigue.
3. Upper and lower carriage brackets – Inspect both carriage brackets for warps, cracks, separation from the carriage plate, rusting and corrosion.
4. Labels – Examine all of the labels. They should be undamaged and easily readable from a reasonable distance. Replace labels that are damaged or not easily readable.
5. Complete unit – Examine the entire unit. Look for rusting/metal erosion. Remove rust/corrosion with a steel bristle brush or steel wool. Clean affected areas and apply touchup paint.

Annual Inspection — Authorized qualified inspection personnel should use the coil mover to lift a full capacity load at least once per year. Afterwards, conduct a Monthly Inspection.

## MAINTENANCE

Perform maintenance on the coil mover each time a *MONTHLY INSPECTION* is performed to ensure that the product remains in satisfactory condition for as long as possible. The OSHA “General Industry” standard for “Powered industrial trucks” ([29 CFR 1910.178](#)) provides recommended maintenance procedures. The following steps should be utilized in conjunction with those procedures. ONLY trained, authorized personnel or contractors should inspect and maintain this device.

**NOTE:** The end-user is responsible for selecting and training employees to inspect and maintain the coil mover.

**Step 1:** Tag the unit “Out of Service.”

**Step 2:** Remove dirt or other matter from all surfaces.

**Step 3:** Conduct a *MONTHLY INSPECTION*.

**Step 4:** Perform all adjustments and repairs necessary to restore the coil mover to *satisfactory condition*. DO NOT modify the unit in any way.

**NOTE:** Adjustments are simple corrections such as tightening loose fasteners and removing dirt or other debris from the surface. Repairs involve removing worn parts and installing manufacturer-approved replacement parts. Modifications are changes that alter the coil mover from satisfactory condition, like bending the structural members and removing parts. **NEVER** modify the device without express, written approval from Vestil. Modifications might make the device unsafe to use and automatically void the *LIMITED WARRANTY* on p. 9.

**Step 5:** Make a dated record of all repairs, adjustments and/or replacements.

## LABELING DIAGRAM

Label content and location are subject to change so your product might not be labeled exactly as shown. Compare the diagram below with the *RECORD*. If you have any questions about labeling, contact *TECHNICAL SERVICE*. Replace all labels that are damaged, missing, or not easily readable (e.g. faded). To order replacement labels, contact the technical service and parts department online at [http://www.vestilmfg.com/parts\\_info.htm](http://www.vestilmfg.com/parts_info.htm). Alternatively, request replacement parts and/or service by calling (260) 665-7586 and asking the operator to connect you to *TECHNICAL SERVICE*.

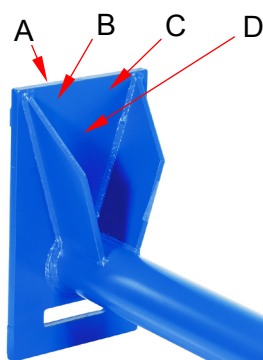

A: Label 1001 (on top)

**USE THIS SIDE UP ONLY**

B: LABEL 1049

<b>⚠ WARNING</b>
<p>Improper use of this fork attachment might result in death or serious injury.</p> <ul style="list-style-type: none"> <li>Using this front end attachment affects lift truck center of gravity.</li> <li>Before using this fork attachment, US Federal regulation 29 CFR 1910.178 requires you to contact the manufacturer of your lift truck and request:                     <ol style="list-style-type: none"> <li>Written approval [29 CFR 1910.178(a)(4)]</li> <li>Markings for (fork) lift truck that:                             <ul style="list-style-type: none"> <li>Identify the attachment;</li> <li>Give approximate weight of truck and attachment at maximum elevation with laterally-centered load. [29 CFR 1910.178(a)(5)].</li> </ul> </li> </ol> </li> <li><b>DO NOT</b> use <b>UNTIL</b> lift truck is marked with corrected capacity tags.</li> <li>CAPACITY OF TRUCK &amp; ATTACHMENT COMBINATION MIGHT BE LESS THAN CAPACITY OF ATTACHMENT. CONSULT TRUCK CAPACITY TAG/LABEL.</li> </ul> <p style="text-align: right;"><small>1049 rev 11/20</small></p>

C: Label 1153

<p>MODEL / MODÉLO / MODÈLE _____</p> <p>WEIGHT / PESO / MASS _____</p> <p>CAPACITY / CAPACIDAD / CAPACITÉ _____</p> <p>SERIAL / SERIE / SÉRIE _____</p> <p style="text-align: center;"><small>UNITS: 2.2 lb. = 1kg      1" (or 1in.) = 2.54cm</small></p> <p style="text-align: right;"><small>1153</small></p>
---

D: Label 821

 <small>821 rev 01/20</small>	<b>⚠ WARNING</b>
<p>Risk of serious injury or death. Read and understand entire owner's manual <b>BEFORE</b> using.</p>	

## LIMITED WARRANTY

Vestil Manufacturing Corporation (“Vestil”) warrants this product to be free of defects in material and workmanship during the warranty period. Our warranty obligation is to provide a replacement for a defective, original part covered by the warranty after we receive a proper request from the Warrantee (you) for warranty service.

### Who may request service?

Only a warrantee may request service. You are a warrantee if you purchased the product from Vestil or from an authorized distributor AND Vestil has been fully paid.

### Definition of “original part”?

An original part is a part used to make the product as shipped to the Warrantee.

### What is a “proper request”?

A request for warranty service is proper if Vestil receives: 1) a photocopy of the Customer Invoice that displays the shipping date; AND 2) a written request for warranty service including your name and phone number. Send requests by one of the following methods:

<u>US Mail</u>	<u>Fax</u>	<u>Email</u>
Vestil Manufacturing Corporation 2999 North Wayne Street, PO Box 507 Angola, IN 46703	(260) 665-1339 <u>Phone</u> (260) 665-7586	<a href="mailto:info@vestil.com">info@vestil.com</a> Enter “Warranty service request” in subject field.

In the written request, list the parts believed to be defective and include the address where replacements should be delivered. After Vestil receives your request for warranty service, an authorized representative will contact you to determine whether your claim is covered by the warranty. Before providing warranty service, Vestil will require you to send the entire product, or just the defective part (or parts), to its facility in Angola, IN.

### What is covered under the warranty?

The warranty covers defects in the following original, dynamic parts: motors, hydraulic pumps, electronic controllers, switches, and cylinders. It also covers defects in original parts that wear under normal usage conditions (“wearing parts”), such as bearings, hoses, wheels, seals, brushes, and batteries.

### How long is the warranty period?

The warranty period for original dynamic components is 90 days. For wearing parts, the warranty period is 90 days. Both warranty periods begin on the date Vestil ships the product to the Warrantee. If the product was purchased from an authorized distributor, the periods begin when the distributor ships the product. Vestil may, at its sole discretion, extend a warranty period for products shipped from authorized distributors by up to 30 days to account for shipping time.

### If a defective part is covered by the warranty, what will Vestil do to correct the problem?

Vestil will provide an appropriate replacement for any *covered* part. An authorized representative of Vestil will contact you to discuss your claim.

### What is not covered by the warranty?

The Warrantee (you) are responsible for paying labor costs and freight costs to return the product to Vestil for warranty service.

### Events that automatically void the Limited Warranty.

- Misuse;
- Negligent assembly, installation, operation or repair;
- Installation/use in corrosive environments;
- Inadequate or improper maintenance;
- Damage sustained during shipping;
- Collisions or other accidents that damage the product;
- Unauthorized modifications: Do not modify the product IN ANY WAY without first receiving written authorization from Vestil.

### Do any other warranties apply to the product?

Vestil Manufacturing Corp. makes no other express warranties. All implied warranties are disclaimed to the extent allowed by law. Any implied warranty not disclaimed is limited in scope to the terms of this Limited Warranty. Vestil makes no warranty or representation that this product complies with any state or local design, performance, or safety code or standard. Noncompliance with any such code or standard is not a defect in material or workmanship.

